

FORM NO. 1.

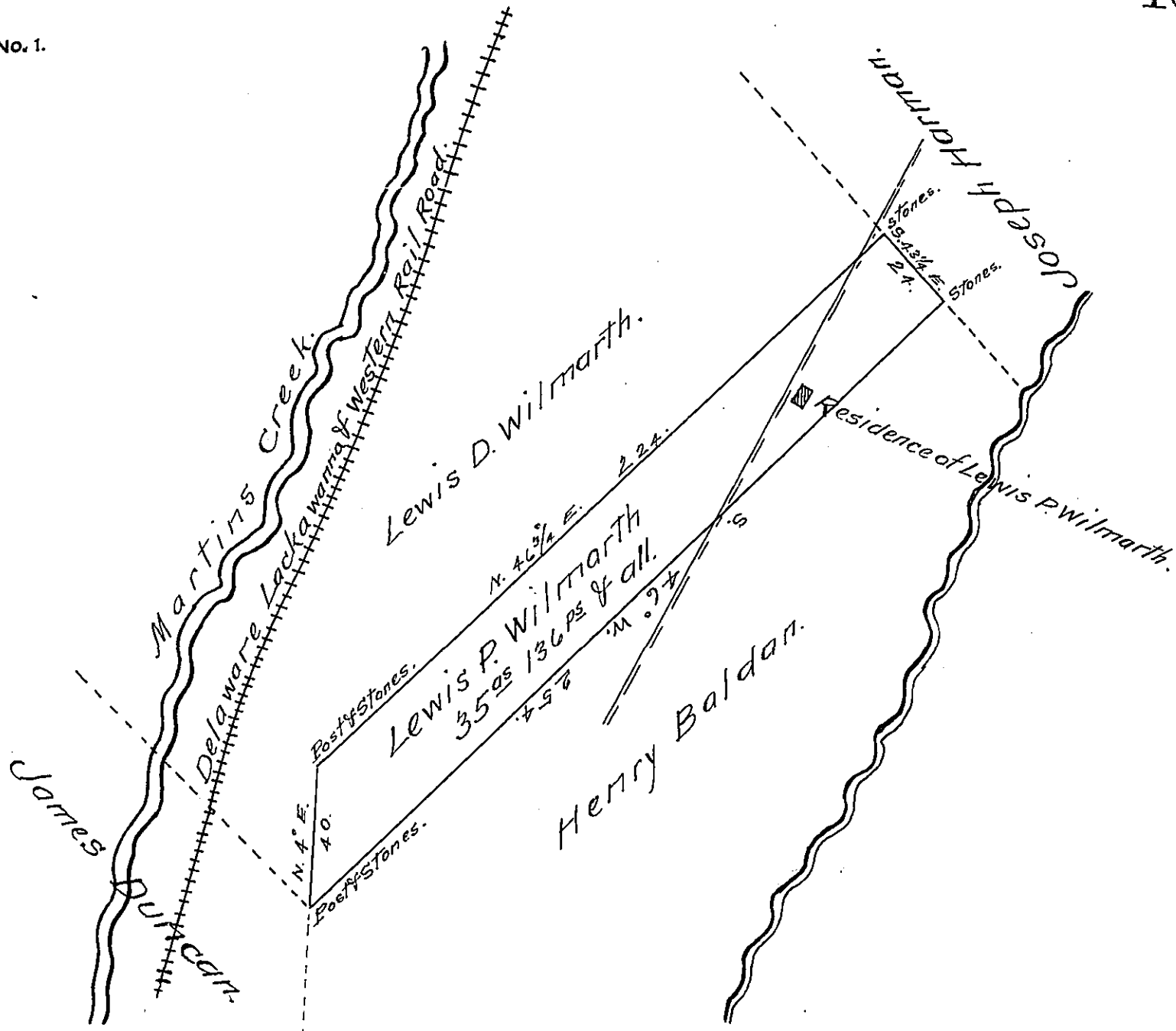

Draught of a tract of land Situate in Harford township
Susquehanna County adjoining lands of Henry Baldan
on the South East, Lewis D. Wilmarth on the South West-
and North West and Joseph Harmon on the North East.-
Surveyed December 13th 1853 for Lewis P. Wilmarth in pursuance
of his improvement warrant bearing date the sixth day of
December A. D. 1853 Containing thirty five acres and one hun-
dred and thirty six perches and the allowance of six per-
cent for roads &c.

Note - 30 acres and 152 perches of the above tract of land is claimed
by Crawford Titus - on which there is an improvement of about four
acres. with an unoccupied dwelling house - the property of Lewis
P. Wilmarth (so reported)

T. J. Porter Brawley Esq.
Surveyor General.

Timothy Boyle Surv-
for Susquehanna County

IN TESTIMONY that the above is a copy of the original remaining on file in
the Department of Internal Affairs of Pennsylvania, made
conformably to an Act of Assembly approved the 16th day of
February 1833, I have hereunto set my hand and caused
the Seal of said Department to be affixed at Harrisburg,
this eleventh day of June 1907.

Henry Howell
Secretary of Internal Affairs.